



SUNNINGDALE PARISH COUNCIL

The Pavilion, Broomhall Lane, Sunningdale, SL5 0QS

☎ 01344 874268

Email: info@sunningdaleparish.org.uk

www.sunningdale-pc.org.uk

Clerk: Ruth Davies

Toby Fox
Case Officer
RBWM

3 August 2023

Dear Toby

**23/01662/TPO: Ash Lodge 37 Station Road Sunningdale Ascot SL5 0QL
Ti - Beech - Crown lifting on west sector to 3.5m above ground level (058/1991/TPO)**

Sunningdale Parish Council considered this application at the Planning Committee on 1 August 2023 and has a **concern** about the proposed tree reduction.

This application is for raising the canopy of a Beech tree, on the west sector over garden up to 3.5m from ground level to maintain useable garden area beneath. See diagram to the right.

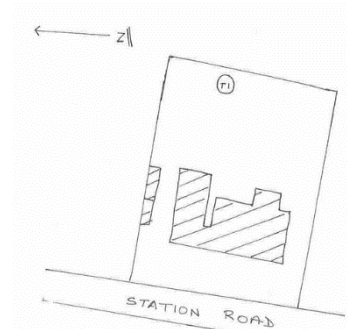

The application states that the tree proposed for reduction is a TPO tree, but no Arboricultural Report has been uploaded to support this application.

The Planning Committee requests more information and imagery to support the application, to help identify the condition of the tree.

Sunningdale Parish Council request that RBWM obtain professional tree advice to examine this in some detail.

Sunningdale Parish Council asks that until additional information is received, **no decision is made** on this application.

Yours sincerely

Anne-Catherine Buxton
Chair of the Planning Committee